

## INTENDED USE

Mekano CH100 2T Tilt bracket can be used to hinge CH100 2T channel for many purposes. The hinged connection is made using M10 self locking anti vibration fasteners.

## INSTRUCTION FOR USE

The tilt bracket is attached to the end of the support channel and attached securely with M10 self locking, anti vibration fasteners.

The channel which is to be hinged is attached also using M10 bolts. When the equipment is in the normal service position, all bolts must be securely tightened.

When the equipment is to be moved for maintenance, the hinge bolt and locking bolt can be loosened slightly to allow the channel to be moved.

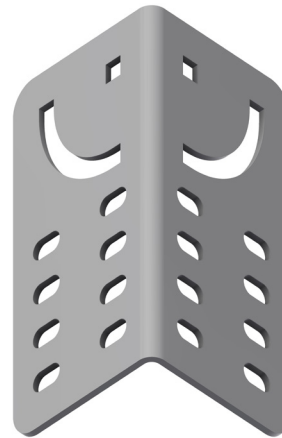

### Typical application:

Equipment stand of Mekano® 2T channel with hinged connection to allow for easy access for maintenance.



User Guide for Bolts:  
Recommended Torque