

INTENDED USE

Straps to ground the support sections to the structure, and to bond between ladders when using movable splices.

INSTRUCTION FOR USE

The straps are fitted using the corresponding bolts according to the strap rating. To avoid corrosion of the earth links, we recommend welding a stainless steel boss to the support structure. Clean and paint over the welded area.

ALTERNATIVE SOLUTION

Good earthing can be obtained by using welded starter brackets on the structure and installing Mekano® channels in Multigrid® system. This provides a mesh of strong grounding points at regular intervals rather than using specifically placed welding bosses and straps. This regular grounding can also help to reduce EMI in installations.

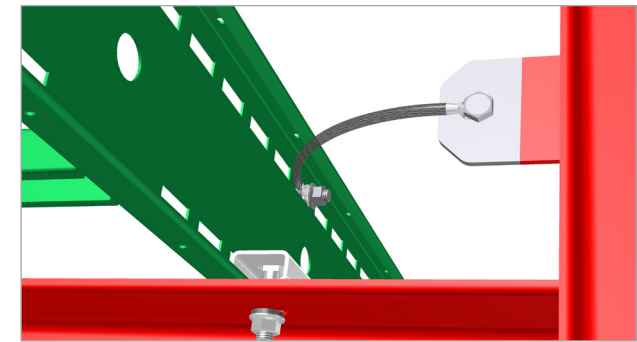
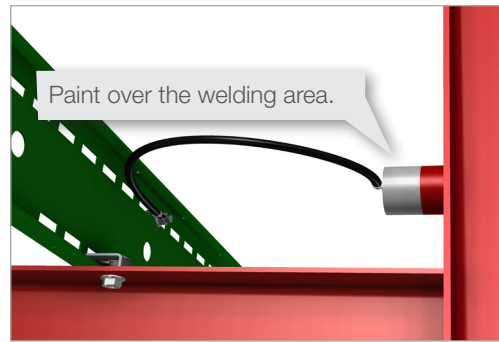

Don't let this happen: Use a stainless steel grounding lug to prevent a potential corrosion problem.

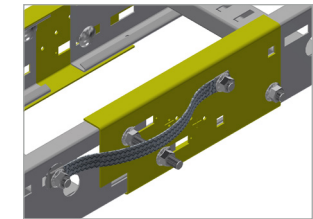
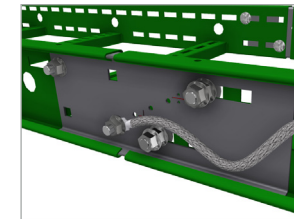

Movable Splices:
Earth link strap used to ensure conductivity over an expansion splice connector.

