

INTENDED USE

For fastening OE cable ladders to support with the fixing located on the inside of the ladder rail. Brackets are available with lateral or longitudinal slots.

INSTRUCTION FOR USE

Attach the parts together loosely using self locking bolts. Adjust all parts and tighten securely.

Where different materials must be insulated from one another, Teflon Sleeves can be fitted between the clamp and the support, and PTFE Insulation Sleeves used to insulate the fasteners.

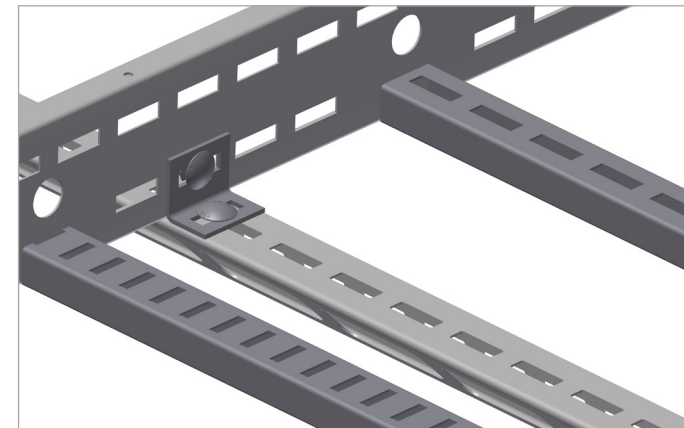
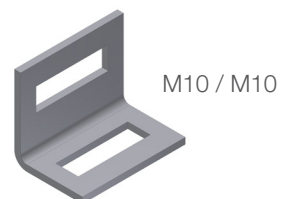

User Guide for Bolts:
Recommended Torque