

X-GR Grating Fastening System

Product data

Dimensions

X-GR

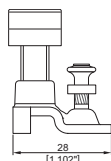
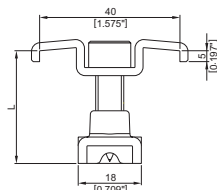

X-R 20-4.0 Zn P8

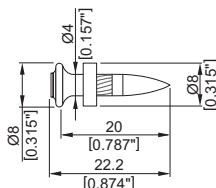

General information

Material specifications

Screw:

Carbon steel

Zinc coating: Duplex* coated

Nail:

Stainless steel: CrMnMo Alloy and zinc coated

Upper part:

Carbon steel: DD11 or DC01

Zinc coating: Duplex* coated

Bottom part:

Carbon steel: S315MC or DC04

Zinc coating: Duplex* coated

*) 480 h salt spray test per DIN 50021 and 10 cycles
Kesternich test per DIN 50018/2.0 (comparable to 45 µm HDG steel)

Recommended fastening tools

DX 460 GR and **DX 5 GR** with

X-5-460-F8GR fastener guide

See **X-GR fastener program** in the next pages and **Tools and equipment** chapter for more details.

Application

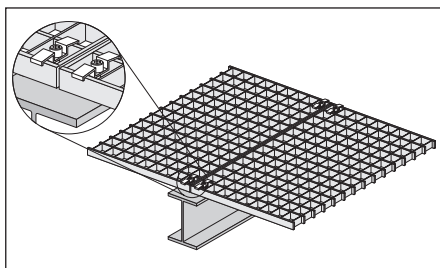

Fastening of grating

For fastenings exposed to weather and mildly corrosive conditions.

Not for use in marine atmospheres (upstream)!

Load data

Recommended tensile loads N_{rec} [kN]

$N_{rec} = 0.8 \text{ kN (180 lb)}$

Notes/Conditions:

- Tensile loading is limited by plastic deformation of the saddle clip
- X-GR resists shear by friction and is not suitable for explicit shear load designs

Application requirements

Thickness of base material

$t_{II} \geq 4 \text{ mm (0.157"')}$

Thickness of fastened material

Grating height: $H_G = 25\text{--}40 \text{ mm (0.98"'\text{--}1.57"')$

Grating opening types

Bearing bar spacing (a)

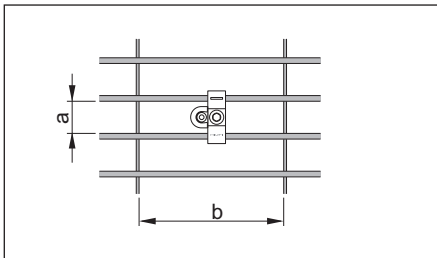

a from 25 to 32 mm (1" to 1 1/4")

Cross bar spacing (b)

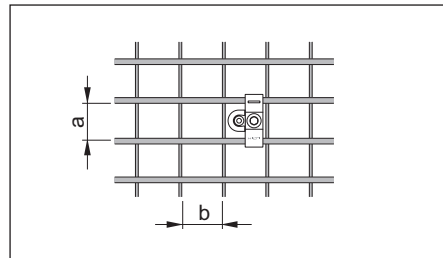

b \geq 30 mm (1.18")

Edge distances

$c \geq 15 \text{ mm (0.59"')}$

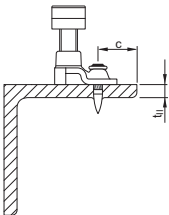

Corrosion information

For fastenings exposed to weather and mildly corrosive conditions. **Not for use in marine atmospheres (upstream)** or in heavily polluted environments.

Application limits

X-GR with DX 460, DX 5

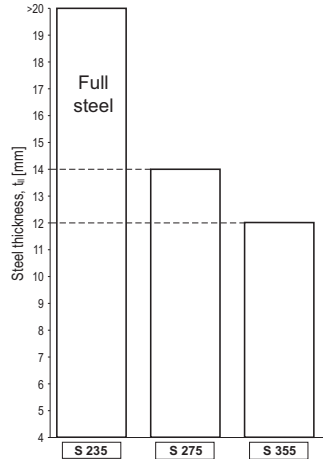
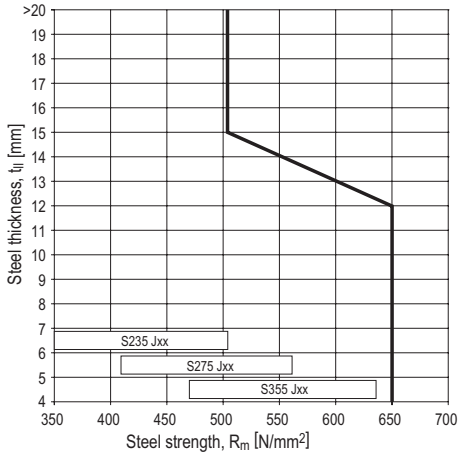

- S235: No application limit
- S275: Full coverage of grade up to 14mm base material thickness
- S355: Full coverage of grade up to 12mm base material thickness

Fastener selection

Fastener	Item no.	L mm (inch)	Grating height mm (inch)
X-GR 25/30	2106415 or 2154241	32 (1.26")	25–30 (0.98"–1.18")
X-GR 1 ¹ / ₄ "	2106416 or 2154243	34 (1.34")	27–32 (1.06"–1.26")
X-GR 35/40	2106417 or 2154242	42 (1.65")	35–40 (1.38"–1.57")

Cartridge selection and tool energy setting

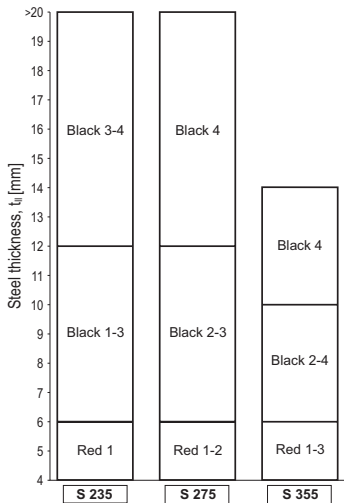

DX 460, DX 5 with 6.8/11M cartridges

Fastening quality assurance

Tighten the screw

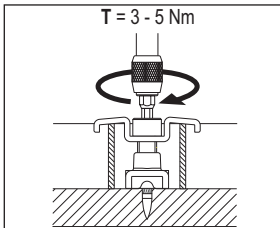

$T_{rec} = 3-5 \text{ Nm}$ (2.2-3.7 ft-lb)

Tightening tool:

- Screwdriver with torque release coupling (TRC)
- 6 mm Allen-type bit

Hilti screwdriver Torque setting

SF 121-A	4-6
SF 150-A	3-5
SF 14	3-5
SFC 14-A	4-6
SF 18-A	3-5
SFC 18-A	3-5
SFC 22-A	3-5
SBT 4-A22	3-4

Fastening inspection

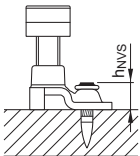

$h_{NVS} = 7 - 10.5 \text{ mm}$ (0.28v"-0.41")

Observing the cartridge selection and tool energy setting typically leads to a stand-off between 9 and 10 mm.

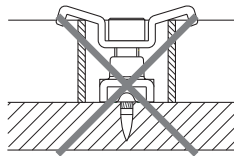

The saddle of the fastener should not be bent, see installation instruction above.